

TRI CLAMP -SANITARY DIAPHRAGM SEAL

SSKE-25

APPLICATIONS

- Food Industries
- Dairy Industries
- Pharmaceuticals Industries

FEATURES

- Single piece construction
- Flushed diaphragm
- Tri Clamp Connection
- Quick Connection



Tri Clamp Sanitary DIAPHRAGM SEAL, TG125

-1...0 bar to 0...40 bar Tri-Clamp

DESCRIPTION

General

Storage temperature : -40...+65°C

Service temperature : 370°C max.

Weld joints : Welded for Diaphragm

Material of construction

Sensing element : Diaphragm

Diaphragm : AISI 316L SS

Chamber material : AISI 316 SS / AISI 316L SS

Filling liquids Vs Temperature range

CODE	Fluid Name	Temperature Range
L1	Silicon DC 200	-40°C to 205°C
L2	Glycerin	10°C to 150°C
L3	Food Grade oil	-20°C to 140°C
L4	Syltherm 800	-40°C to 315°C
L5	Silicon DC 710	7°C to 371°C

Standard version

Seal type : -1.0 bar to 0...40 bar

Instrument connection : 1/2" NPT (F)

Sealing fluid : Silicon DC 200 [-40...205°C]

Process connection: 1.5" Connection

GA DRAWING

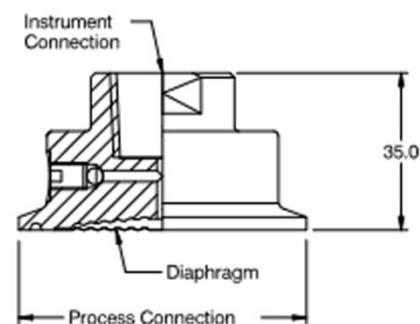

NOTES

1. Standard GA Drawing. Not to scale.
2. Detailed GA Drawings are available, kindly contact factory.

Conn. Size	Range	Conn. Size	Range
1"	0...4 to 0...40Bar	2"	0...1 to 0...40bar
1.5"	0...2 to 0...40bar	2.5"	-1...0 to 0...40bar

TRI CLAMP -SANITARY DIAPHRAGM SEAL

SSKE25

ORDERING CODES

MODEL								SSKE25
SSKE25 Tri Clamp Flush diaphragm								
seal SEAL TYPE								R01
R01	0...4 to 0...40Bar	R01	0...2 to 0...40bar	R01	0...1 to 0...40bar	R01	-1...0 to 0...40bar	
DIAPHRAGM								S03
S03	AISI 316L SS							
BOTTOM CHAMBER								S02
S02	AISI 316 SS		S03	AISI 316L SS				
INSTRUMENT CONNECTION								P28
P27	1/2" BSP (F)		P28	1/2" NPT (F)				
PROCESS CONNECTION								P08
TR01	1" Tri Connection		TR02	1.5" Tri Connection		TR03	2" Tri Connection	
SEALING FLUID								L1
XX	As per Filling liquid Vs Temperature Rating table							
EXECUTION								R1
R1	Direct							
OTHER OPTIONS								XX
E77	Dry Seal		E31	Material test certificate 3.1		E32	Material test certificate 2.2	

Ordering Example : SSKE25-R01.S03.S02.P28.TR01.L1.R1/XX