

# SILIP RING COUPLED DIAPHRAGM SEAL SSKE22-2

## APPLICATIONS

- Separation systems
- Isolation applications
- Viscous & corrosive media
- High-pressure applications
- High vibration application

## FEATURES

- Rigid construction
- Forged sealing chambers
- Laser welded diaphragm
- Optional exotic materials



SLIP RING COUPLED DIAPHRAGM SEAL, SSKE22-2

## DESCRIPTION

### General

**Thread design :** ANSI B1.20.1 / BS EN ISO 228-1

**Storage temperature :** -40...+65°C

**Service temperature :** 370°C max.

**Weld joints :** Laser welding for Diaphragm and  
TIG argon arc welding for other parts

### Material of construction

**Sensing element :** Diaphragm

**Top chamber material :** ASTM A105 / AISI 304 SS / AISI 316 SS

**Diaphragm :** AISI 316L SS / Monel 400 / Hastelloy C-276  
Inconel 600 / Titanium / Tantalum

**Bottom chamber material :** AISI 304SS / AISI 316 SS

AISI 316L SS / Monel / Titanium / Tantalum  
Hastelloy C-276 / PVC<sup>#</sup> / PVDF<sup>#</sup> / Polypropylene<sup>#</sup>  
PTFE<sup>#</sup>

**Slip Ring material :** AISI 304SS (R02,R08)/  
Steel Powder coated(R01)

**Capillary :** AISI 304 SS / AISI 316 SS

**Armour :** AISI 304 SS / AISI 316 SS / PVC

**Remote distance :** 0.25 Mtr. to 25 Mtr.

### Standard version

**Seal type :** -1...0...70 bar [Standard] / 100...210 bar [High Pr. 1]  
250...400 bar [High Pr. 2]

**Instrument connection :** ½" NPT (F) / ½" BSP (F)

**Sealing fluid :** Silicon DC 200 [-40...205°C]

**Process connection :** ½" NPT (M) / ½" BSP (M)

### Wetted parts protection

**Lining on bottom chamber [Code E67]**

**Material :** PTFE - 2 mm thick

**Service temperature :** 200°C max.

**Lining on Diaphragm [Code E68]**

**Material :** PTFE - 100 Micron thick

**Service temperature :** 150°C max.

**Coating on Bottom chamber & diaphragm [Code E69]**

**Material :** PTFE [spray coated & oven baked]

**Service temperature :** 150°C max.

### Filling liquids Vs Temperature range

CODE	Fluid Name	Temperature Range
L1	Silicon DC 200	-40°C to 205°C
L2	Glycerin	10°C to 150°C
L3	Food Grade oil	-20°C to 140°C
L4	Syltherm 800	-40°C to 315°C
L5	Silicon DC 710	7°C to 371°C

# SILIP RING COUPLED DIAPHRAGM SEAL SSKE22-2

## ORDERING CODES

<b>MODEL</b>						<b>SSKE22-2</b>
SSKE22-2 Slip Ring diaphragm seal						
<b>SEAL TYPE</b>						<b>R02</b>
R01	-1...0...21 bar [Eco]	R02	-1...0...70 bar [Standard]	R08	100...400 bar [High pressure]	
<b>TOP CHAMBER</b>						<b>S01</b>
S09	ASTM A105	S01	AISI 304 SS	S02	AISI 316 SS	
<b>DIAPHRAGM</b>						<b>S03</b>
S03	AISI 316L SS	S05	Monel 400	S10	Hastelloy C-276	
S06	Inconel 600	S07	Titanium	S08	Tantalum	
<b>BOTTOM CHAMBER</b>						<b>S02</b>
S01	AISI 304 SS	S02	AISI 316 SS	S03	AISI 316L SS	
S05	Monel 400	S10	Hastelloy C-276	S07	Titanium	
S08	Tantalum	S11	PTFE	S16	PVC	
S18	Polypropylene	S19	PVDF			
<b>INSTRUMENT CONNECTION</b>						<b>P28</b>
P28	1/2" NPT (F)	P23	1/4" BSP (F)	P27	1/2" BSP (F)	
P24	1/4" NPT (F)					
<b>PROCESS CONNECTION</b>						<b>P08</b>
P04	1/4" NPT (M)	P08	1/2" NPT (M)	P20	M20 X 1.5 mm (M)	
P03	1/4" BSP (M)	P05	3/8" BSP (M)	P07	1/2" BSP (M)	
P28	1/2" NPT (F)	P23	1/4" BSP (F)	P27	1/2" BSP (F)	
P24	1/4" NPT (F)					
All other connections are available on request.						
<b>SEALING FLUID</b>						<b>L1</b>
XX	As per Filling liquid Vs Temperature Rating table					
<b>EXECUTION</b>						<b>R1</b>
R1	Direct	R2	Remote			
<b>CAPILLARY MATERIAL</b>						<b>XX</b>
S01	AISI 304 SS	S02	AISI 316 SS			
<b>ARMOUR MATERIAL</b>						<b>XX</b>
S01	AISI 304 SS	S02	AISI 316 SS	S16	PVC [Ambient ≤60°C]	
<b>REMOTE DISTANCE</b>						<b>XXXXX</b>
XXXXX	500 mm (Min.) to 25000 mm (Max.)					
<b>OTHER OPTIONS</b>						<b>XXX</b>
E77	Dry Seal	E31	Material test certificate 3.1	E32	Material test certificate 2.2	

Ordering Example : SSKE22-2-R02.S01.S03.S02.P28.P08.L1.R1/XX.XX.XXXXX/XXX

## GA DRAWING

R01

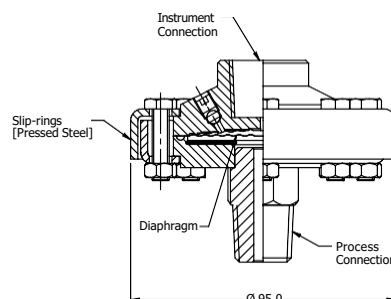

R02 & R08

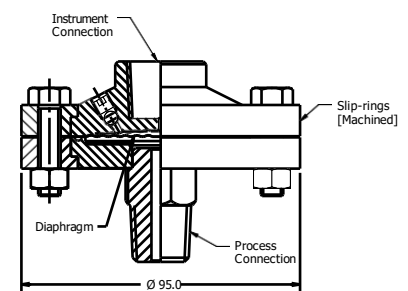

### NOTES

- Standard GA Drawing. Not to scale.
- Detailed GA Drawings are available, kindly contact factory.

## SHREE SAMARTH KRUPA ENGINEERS

Contact : +91 8155865961, +919586682557

prakash@shree-samarthkrupa.com, www.shree-samarthkrupa.com