

FULLY WELDED DIAPHRAGM SEAL -HEAVY DUTY SEAL SSKE21

APPLICATIONS

- Separation systems
- Isolation applications
- Viscous & corrosive media
- High-pressure & vibration applications

FEATURES

- Economical and light weight
- All welded construction



FULLY WELDED DIAPHRAGM SEAL-HEVY DUTY, SSKE21

DESCRIPTION

General

Thread design : ANSI B1.20.1 / BS EN ISO 228-1

Storage temperature : -40...+65°C

Service temperature : 370°C max.

Weld joints : Laser welding for Diaphragm and
TIG argon arc welding for other parts

Material of construction

Sensing element : Diaphragm

Top chamber material : AISI 304 SS / AISI 316 SS

Diaphragm : AISI 316L SS / Monel 400 / Hastelloy C-276
Inconel 600 / Titanium / Tantalum

Bottom chamber material : AISI 304SS / AISI 316 SS
AISI 316L SS / Monel / Titanium / Tantalum
Hastelloy C-276

Capillary : AISI 304 SS / AISI 316 SS

Armour : AISI 304 SS / AISI 316 SS / PVC

Remote distance : 0.25 Mtr. to 15 Mtr.

Filling liquids Vs Temperature range

| CODE | Fluid Name | Temperature Range | Seal type | Range | ØD |
|------|----------------|-------------------|-----------|---------------------------------|-------|
| L1 | Silicon DC 200 | -40°C to 205°C | R04 | -1...0...2.5 bar [Low Pressure] | Ø62.2 |
| L2 | Glycerin | 10°C to 150°C | R05 | 4...70 bar [Standard] | Ø55.0 |
| L3 | Food Grade oil | -20°C to 140°C | R06 | 100...280 bar [High Pressure 1] | Ø46.5 |
| L4 | Syltherm 800 | -40°C to 315°C | R07 | 350...700 bar [High Pressure 2] | Ø34.0 |
| L5 | Silicon DC 710 | 7°C to 371°C | | | |

Standard version

Seal type : -1...0...2.5 bar [Low Pr.] / 6...70 bar [Standard]
100...280 bar [High Pr. 1] / 350...700 bar [High Pr. 2]

Instrument connection : ½" NPT (F) / ½" BSP (F)

Sealing fluid : Silicon DC 200 [-40...205°C]

Process connection : ½" NPT (M) / ½" BSP (M)

GA DRAWING

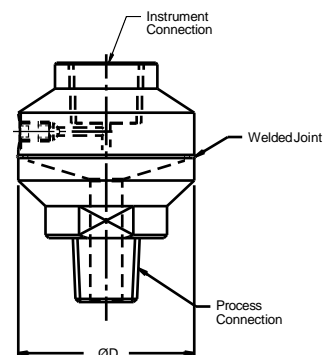

FULLY WELDED DIAPHRAGM SEAL -HEAVY DUTY SEAL

SSKE21

ORDERING CODES

| | | | | |
|---|---|------------|-------------------------------|---------------|
| MODEL | | | | SSKE21 |
| SSKE21 Fully Welded diaphragm | | | | |
| seal SEAL TYPE | | | | R02 |
| R04 | -1...0...2.5 bar [Low Pressure] | R05 | 4...70 bar [Standard] | |
| R06 | 100...280 bar [High Pressure 1] | | | |
| TOP CHAMBER | | | | S01 |
| S01 | AISI 304 SS | S02 | AISI 316 SS | |
| DIAPHRAGM | | | | S03 |
| S03 | AISI 316L SS | S05 | Monel 400 | |
| S06 | Inconel 600 | S07 | Titanium | |
| | | S10 | Hastelloy C-276 | |
| | | S08 | Tantalum | |
| BOTTOM CHAMBER | | | | S02 |
| S01 | AISI 304 SS | S02 | AISI 316 SS | |
| S05 | Monel 400 | S10 | Hastelloy C-276 | |
| S08 | Tantalum | S03 | AISI 316L SS | |
| | | S07 | Titanium | |
| INSTRUMENT CONNECTION | | | | P28 |
| P28 | ½" NPT (F) | P23 | ¼" BSP (F) | |
| P24 | ¼" NPT (F) | | | |
| | | P27 | ½" BSP (F) | |
| PROCESS CONNECTION | | | | P08 |
| P04 | ¼" NPT (M) | P08 | ½" NPT (M) | |
| P03 | ¼" BSP (M) | P05 | 3/8" BSP (M) | |
| P28 | ½" NPT (F) | P23 | ¼" BSP (F) | |
| P24 | ¼" NPT (F) | | | |
| | | P20 | M20 X 1.5 mm (M) | |
| | | P07 | ½" BSP (M) | |
| | | P27 | ½" BSP (F) | |
| All other connections are available on request. | | | | |
| SEALING FLUID | | | | L1 |
| XX | As per Filling liquid Vs Temperature Rating table | | | |
| EXECUTION | | | | R1 |
| R1 | Direct | R2 | Remote | |
| CAPILLARY MATERIAL | | | | XX |
| S01 | AISI 304 SS | S02 | AISI 316 SS | |
| ARMOUR MATERIAL | | | | XX |
| S01 | AISI 304 SS | S02 | AISI 316 SS | |
| | | S16 | PVC [Ambient ≤60°C] | |
| REMOTE DISTANCE | | | | XXXXX |
| XXXXX | 500 mm (Min.) to 25000 mm (Max.) | | | |
| OTHER OPTIONS | | | | XXX |
| E77 | Dry Seal | E31 | Material test certificate 3.1 | |
| | | E32 | Material test certificate 2.2 | |

Ordering Example : SSKE21-R02.S01.S03.S02.P28.P08.L1.R1/XX.XX.XXXXX/XXX

Note : For GA Drawings, kindly contact factory.

SHREE SAMARTH KRUPA ENGINEERS

Contact : +91 8155865961, +919586682557

prakash@shree-samarthkrupa.com, www.shree-samarthkrupa.com