

I - SECTION - FLANGED DIAPHRAGM SEAL

SSKE19

APPLICATIONS

- Separation systems
- Isolation applications
- Viscous & corrosive media
- High-pressure applications
- High vibration application

FEATURES

- For flanges below 1½" size
- Optional exotic materials



I - SECTION - FLANGED DIAPHRAGM SEAL, SSKE19

DESCRIPTION

General

Flange design : ANSI B16.5 / EN 1092-1 / BS-10

Storage temperature : -40...+65°C

Service temperature : 370°C max.

Weld joints : Diaphragm and Other Parts by
TIG argon arc welding

Material of construction

Sensing element : Diaphragm

Top chamber material : ASTM A105 / AISI 304 SS / AISI 316 SS

Diaphragm : AISI 316L SS / Monel 400 / Hastelloy C-276
Inconel 600 / Titanium / Tantalum

Gaskets : PTFE [ranges ≤70 bar] / Metal [ranges ≥100 bar]

Bottom chamber material : ASTM A105 / AISI 304SS

AISI 316 SS / AISI 316L SS / Monel / Titanium

Hastelloy C-276 / Tantalum / PVC# / PVDF#

Polypropylene# / PTFE#

Coupling flanges & hardware : Plated pressed steel [cup type]
AISI 304 SS [machined, for seal type R02 & R03]

Capillary : AISI 304 SS / AISI 316 SS

Armour : AISI 304 SS / AISI 316 SS / PVC

Remote distance : 0.25 Mtr. to 15 Mtr.

Standard version

Seal type : -1...0...21 bar [Eco] / -1...0...70 bar [Standard] /
100...400 bar [High pressure]

Instrument connection : ½" NPT (F) / ½" BSP (F)

Sealing fluid : Silicon DC 200 [-40...205°C]

Process connection : Flange as per standard between ½ to 1¼"

Flange facing type : Flat Face / Raised Face / Ring Type Joint

Wetted parts protection

Lining on bottom chamber [Code E67]

Material : PTFE - 2 mm thick

Service temperature : 200°C max.

Lining on Diaphragm [Code E68]

Material : PTFE - 100 Micron thick

Service temperature : 150°C max.

Coating on Bottom chamber & diaphragm [Code E69]

Material : PTFE [spray coated & oven baked]

Service temperature : 150°C max.

Filling liquids Vs Temperature range

CODE	Fluid Name	Temperature Range
L1	Silicon DC200	-40°C to 205°C
L2	Glycerin	10°C to 150°C
L3	FoodGradeoil	-20°C to 140°C
L4	Syltherm 800	-40°C to 315°C
L5	Silicon DC710	7°C to 371°C

Check temperature & pressure rating with factory before ordering.

I - SECTION -FLANGED DIAPHRAGM SEAL

SSKE19

ORDERING CODES

MODEL				SSKE19		
SSKE19 I - Section diaphragm seal						
SEAL TYPE					R02	
R01	-1...0...21 bar [Eco]	R02	-1...0...70 bar [Standard]			
R03	100...400 bar [High pressure]					
TOP CHAMBER MATERIAL					S01	
S09	ASTM A105	S01	AISI 304 SS			
S02	AISI 316 SS					
DIAPHRAGM MATERIAL					S03	
S03	AISI 316L SS	S05	Monel 400			
S06	Inconel 600	S07	Titanium			
S10	Hastelloy C-276	S08	Tantalum			
BOTTOM CHAMBER MATERIAL					S02	
S01	AISI 304 SS	S02	AISI 316 SS			
S05	Monel 400	S10	Hastelloy C-276			
S08	Tantalum	S11	PTFE		S03	AISI 316L SS
S18	Polypropylene	S19	PVDF		S07	Titanium
S16	PVC					
INSTRUMENT CONNECTION					P28	
P28	½" NPT (F)	P23	¼" BSP (F)			
P24	¼" NPT (F)	P27	½" BSP (F)			
PROCESS CONNECTION				XXX		
XXX	As per Flange table					
FLANGE FACING				G1		
G1	Serrated raised face	G2	Flat face			
G4	Tongue & Groove face	G3	Ring type joint face			
SEALING FLUID				L1		
XX	As per Filling liquid Vs Temperature Rating table					
EXECUTION				R1		
R1	Direct	R2	Remote			
CAPILLARY MATERIAL				XX		
S01	AISI 304 SS	S02	AISI 316 SS			
ARMOUR MATERIAL				XX		
S01	AISI 304 SS	S02	AISI 316 SS			
S16	PVC [Ambient ≤60°C]					
REMOTE DISTANCE				XXXXX		
XXXXX	500 mm (Min.) to 25000 mm (Max.)					
OTHER OPTIONS				XXX		
E77	Dry Seal	E31	Material test certificate 3.1			
E32	Material test certificate 2.2					

Ordering Example : SSKE19-R02.S01.S03.S02.P28.F07.G1.L1.R1/XX.XX.XXXXX/XXX

GENERAL DRAWING

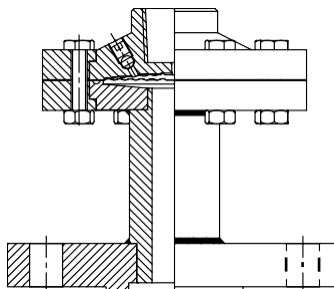

NOTES

1. Standard GA Drawing. Not to scale.
2. Detailed GA Drawings are available, kindly contact factory.

SHREE SAMARTH KRUPA ENGINEERS

Contact : +91 8155865961, +919586682557

prakash@shree-samarthkrupa.com, www.shree-samarthkrupa.com